

## Join a Community

Hickory Homes and Kidron Inc. are both minutes away from Wichita. The communities offer access to a 4-star public golf course, easy access to excellent medical professionals, diverse restaurants and the peaceful comfort of a small-town community.

Hickory Homes is located next to the Dyck Arboretum of the Plains and residents have access to activities with children at the Hesston Intergenerational Child Development Center.

Kidron Inc. is by the Sand Creek Trail which offers three miles of beautiful walking and biking opportunities, connecting the Kidron Inc. campus, Bethel College and the town of North Newton.



# HICKORY HOMES KIDRON INC.

BLUESTEM COMMUNITIES

## Subsidized Housing Opportunities at Bluestem Communities

### Qualifications:

- Meet the income criteria and be 62 years of age or older  
OR
- Have severe mobility impairment which requires wheelchair accessibility

To explore your eligibility and request a trial monthly rent for subsidized housing you will need to provide:

- Gross monthly income
- Assets (bank accounts, property, whole life insurance policies)
- Medical Expenses (health insurance premiums and prescription drug costs)



**For more information,**

please contact:

Rebecca McCoskey, Property Manager

620-327-3790 or 316-836-4859

[rebeccam@bluestemks.org](mailto:rebeccam@bluestemks.org)

## Hickory Homes

There are two floor plan types at Hickory Homes. In the main building we have two additional units adapted with special features for accessibility.

### ► Main building floor plan

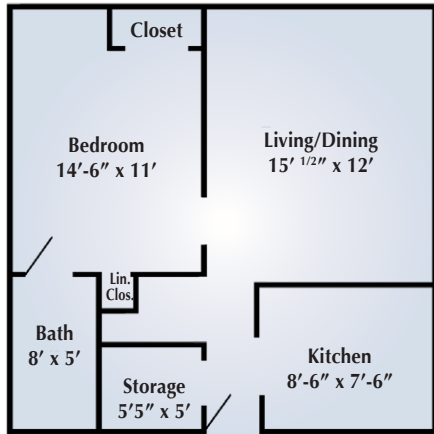

### ► 4-plex floor plan

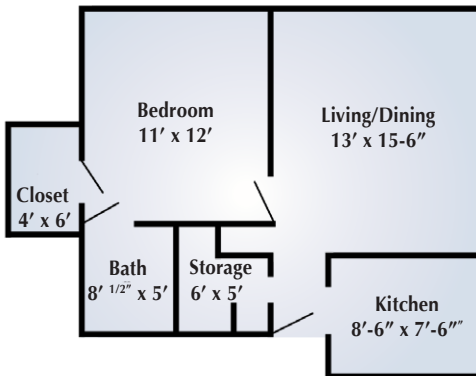

**Hickory Homes**  
 175 W. Hickory • Hesston, KS 67062  
 Phone: 620-327-3790 • Fax: 620-327-3793  
[svilla.org](http://svilla.org)

## Hickory Homes & Kidron Inc. apartments offer:

- Private apartments
- Opportunities to participate in community activities
- A smoke-free campus
- Small pets allowed
- Library with Internet access
- Transition Support program
- Accessibility to the Bluestem Wellness Centers in Hesston and North Newton
- Volunteer opportunities
- Easy access to Harvest Dining, Harvest Table & Water's Edge Hesston
- Gardening opportunities
- Close proximity to the Dyck Arboretum of the Plains and community walking trails
- Enrichment opportunities through Hesston College & Bethel College



## Kidron Inc.

There are two floor plan types at Kidron Inc. In the main building we have two additional units adapted with special features for accessibility and also two additional units that include an extra bedroom for two people.

### ► Main building floor plan

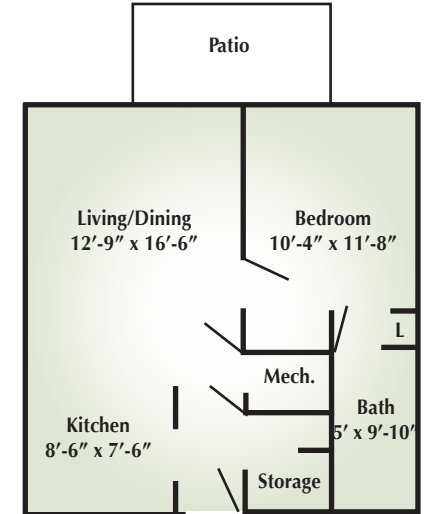

### ► 4-plex floor plan

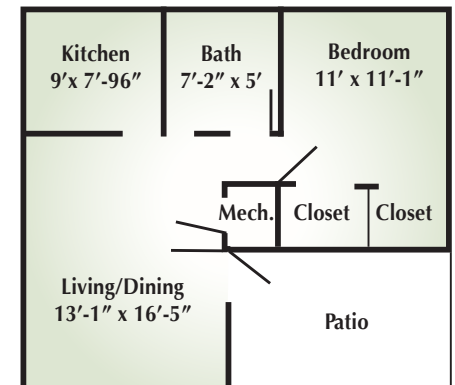

**Kidron Inc.**  
 500 W. Bluestem • North Newton, KS 67117  
 Phone: 316-836-4859 • Fax: 316-284-0173  
[kidronbethel.org](http://kidronbethel.org)